

SANDY CREEK BOARD MEMBERS :

ROD HERRIG AND I (ROSS (JAKE) RABETDY
ARE ATTEMPTING TO START A NEW BUSINESS.

THIS BUSINESS WILL BE LOCATED AT

2246 Cty Rt. 15 SANDY CREEK, NY.

WE WILL BE DOING RV AND TRAILER MAINTENANCE,
PARTS, REPAIR AND RENTAL.

THE BUSINESS NAME WILL BE

FINISHING TOUCH 2.

WE WOULD LIKE TO INSTALL A 4' x 6' SIGN IN
FRONT OF THE BUILDING. THE SIGN WILL READ

FINISHING TOUCH 2

- CAMPER AND UTILITY TRAILER REPAIR

- MAINTENANCE / SANDBLASTING + PAINTING

- CUSTOMIZATION

- RENTALS

315-921-1005

M-F 8-5

315-523-0101

THIS SIGN WILL BE ~~PLACED~~ PLACED 20' FROM THE ROAD
AND WILL HAVE 2 LIGHTS.

WE EXPECT TO HAVE 1-5 UNITS INSIDE THE
BUILDING AND 5-15 UNITS ON THE PROPERTY
BEHIND THE BUILDING.

THERE IS A POSSIBILITY OF 1-2 EMPLOYEES
IN THE FUTURE BUT NOT TO START WITH.

WE BOTH APPRECIATE YOUR TIME AND
CONSIDERATION FOR THIS POSSIBLE NEW
BUSINESS THAT WE CAN BRING TO THE COMMUNITY.

THANK YOU

ROSS (JAKE) RABETON /
ROZ HERZIG /

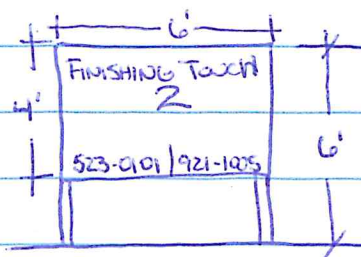

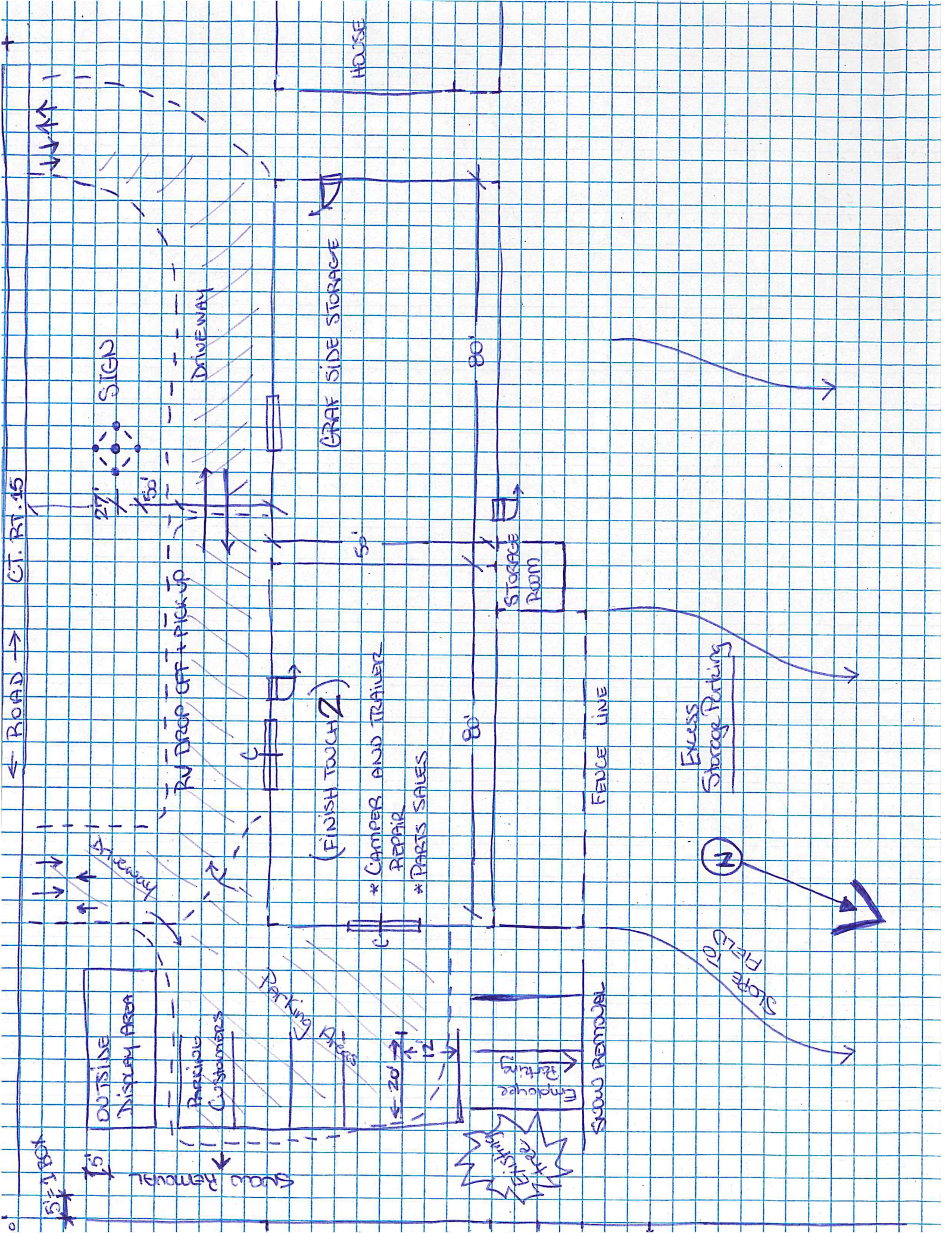

Town of Sandy Creek
Site Plan Review Application
(page 1 of 2)

Name of Applicant: ROSS L. RABETON II 305-921-1005

Applicant Address: 15671 BALCH PLACE RD.
MANNSVILLE, NY 13161

Name of Owner: CARL GRAF

Owner Address: 601 LAKESHORE ROAD
POWASKI, NY 13142

Name of Project: FINISHING TOUCH 2

Project Address: 2246 COUNTY ROUTE 15
SANDY CREEK, NY 13145

If owner is different from applicant, please explain. Friends

Present Zoning NOT-WF Existing Use of Property STORAGE

Project Location: County Rte 15

Type of Project: STORAGE BUILDING to be used for Campar Repair Bldg.

Date the Sketch Plan Conference was held: _____

Attach "Record of Sketch Plan Conference"

Did you remember to include your application and submittal checklist? It is required to apply for a site plan review.

Applicant's Signature

Owner's Signature

Date 4-26-21

Date 4-26-21

Town of Sandy Creek
Site Plan Review Application
(Page 2 of 2)

For Official Use Only:

Date application received by CEO: 5/27/21

CEO: What other agencies have regulatory authority or require a permit? N/A

Date CEO submitted application to Planning Board Secretary: 5/27/21

Date CEO submitted application to Town Clerk: 5/27/21

Date Fee was Paid: 5/27/21

Amount of Fee Paid: \$ 150.00

Application and Fee Received by: JH / Tm
Authorized Local Official

THE FEE MUST BE PAID BEFORE THE APPLICATION IS SUBMITTED TO THE PLANNING BOARD

Planning Board Only:

Date of Sketch Plan Conference: _____

Date Site Plan was formally submitted (after Sketch Plan Conference): _____

Date application deemed complete: _____

Town of Sandy Creek
Application and Submission Requirement Checklist for Site Plan Approval

Requirements which cannot be waived:

- _____ 1. Location map.
- _____ 2. A to-scale plan at a scale of 1" - 50' or larger for parcels of 10 acres or less;
1" - 100' or larger for parcels of more than 10 acres. (See Article IV. 402 d. for more information)
- _____ 3. A landscape plan for the property
- _____ 4. If municipal (community) water and/or sewer is necessary, a letter of approval from the appropriate source
- _____ 5. Names and addresses of property owners who are to be notified of the public hearing in accordance with Section 3.07.
- _____ 6. An environmental assessment form (EAF) and, when applicable, a draft environmental impact statement (EIS) pursuant to 6NYCPR Part 617.

Record of Mandatory Sketch Plan Conference

(Page 2 of 2)

<u>Waived</u>	<u>Required</u>	<u>Initials (PB)</u>	
_____	_____	_____	5. Snow removal plans.
_____	_____	_____	6. The location of refuse storage and removal areas
_____	_____	_____	7. Grading plan
_____	_____	_____	8. A survey by a licensed land surveyor of the parcel on which the development is to occur, or, if only a small portion of a parcel is to be developed, of the area to be developed
_____	_____	_____	9. A drainage plan for the property
_____	_____	_____	10. An erosion control and sediment control plan during and post construction
_____	_____	_____	11. An agricultural data statement pursuant to State law
_____	_____	_____	12. Other as per Planning Board (See Sec 4.02.i.)

Signature of Planning Board Chairperson

Date

The applicant shall have 180 days after this conference to formally submit the Site Plan with these requirements. After 180 days, approved waivers shall be null and void.